



Stowe DX

(Model 8322)



GAS-FIRED DIRECT-VENT HEATER

Parts List Exploded View & Key

Operate and Maintain This Gas Heater
According To the Instruction Manual.

	We recommend that our gas hearth products be installed and serviced by professionals who are certified in the U.S. by the National Fireplace Institute® (NFI) as NFI Gas Specialists.
--	---



-  **WARNING: FOLLOW THE INFORMATION IN THE OWNER'S MANUAL AND ANY KIT INSTRUCTIONS EXACTLY WHEN MAINTAINING THIS APPLIANCE! IF NOT, A FIRE OR EXPLOSION MAY RESULT CAUSING PROPERTY DAMAGE, PERSONAL INJURY OR LOSS OF LIFE.**
-  **WARNING: DO NOT STORE OR USE GASOLINE OR ANY OTHER FLAMMABLE VAPORS AND LIQUIDS NEAR THIS OR ANY OTHER GAS APPLIANCE.**
-  **A QUALIFIED INSTALLER, SERVICE AGENCY, OR GAS SUPPLIER MUST PERFORM INSTALLATION AND SERVICE OF THIS APPLIANCE.**

In the Commonwealth of Massachusetts, all installation of gas lines and gas fittings must be performed by a licensed gas fitter or licensed plumber.

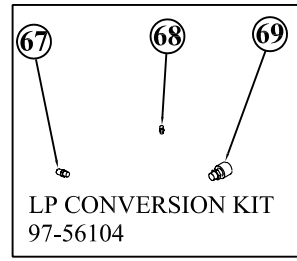
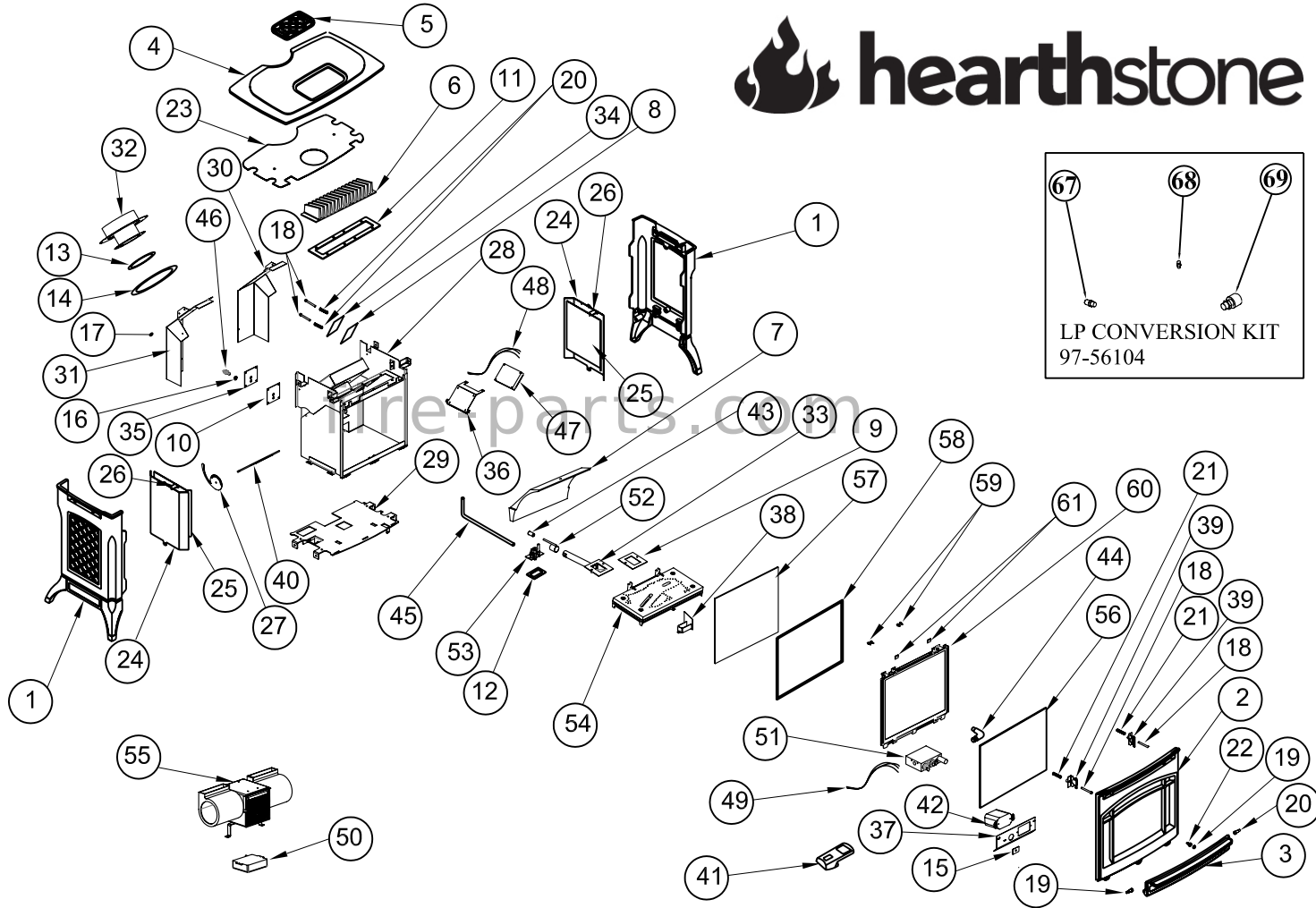
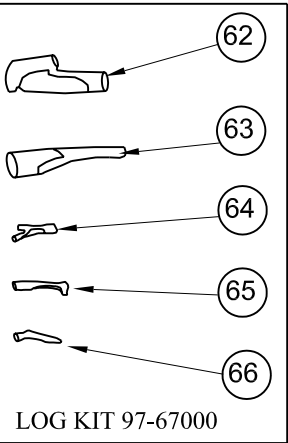



Stowe 8322 Exploded View Key

Key	Component	Object Description	Qty
1	2310-331	SIDE	2
2	2310-431	FRONT	1
3	2310-433	VALVE CONTROL DOOR	1
4	2310-831	TOP	1
5	2310-835	GRILLE	1
6	2710-487	HEAT EXCHANGER	1
7	3120-150	BAFFLE: CERAMIC	1
8	3160-105	GASKET: DELAYED IGNITION RELIEF	1
9	3160-106	GASKET: VENTURI /BURNER	1
10	3160-107	GASKET: REAR ORIFICE PLATE	1
11	3160-150	GASKET:HEAT EXCHANGER,4"x14.5	1
12	3160-152	GASKET: PILOT,1.75"x3",ADHESIVE BACK	1
13	3160-155	GASKET: EXIT,4"x6"	1
14	3160-157	GASKET: INLET,6-1/2"x9-5/16"	1
15	3300-549	LABEL: IPI/CONTINUOUS PILOT	1
16	4200-0090	NUT: JAM,1/8" NPT,BRASS	1
17	4200-0340	1/4" PUSH NUT (AIR SHUTTER STOPPER)	1
18	4500-1420	SCREW: CAP,1/4-20x2-1/4",LOW PRO,SOCKET	4
19	4500-3085	SCREW: SHOULDER,5/16"Dx1/2"L,SOCKET	2
20	4700-0800	MAGNET: VALVE DOOR,3/4"Dx3/16"	1
21	5240-150	SPRING: COMPRESSION,17-7 PH SS	4
22	5300-160	MOUNT: MAGNET	1
23	5320-020	HEATSHIELD: TOP	1
24	5320-030	HEATSHIELD: SIDE,OUTER	2
25	5320-031	HEATSHIELD: SIDE,INNER	2
26	5320-032	SPACER: HEATSHIELD,SIDE	4
27	5322-078	HANDLE: RESTRICTOR DISC	1
28	5322-200	FIREBOX	1
29	5322-220	BASE: PLATE	1
30	5322-274	DEFLECTOR: FAN, REAR RIGHT	1
31	5322-275	DEFLECTOR: FAN, REAR LEFT	1
32	5701-924HB	COLLAR: INLET/EXIT,4"x6-5/8"	1
33	5710-015	VENTURI: BURNER TUBE	1
34	5710-100	PLATE:DELAYED IGNITION	1
35	5710-210	PLATE: REAR ORIFICE	1
36	5710-211	SUPPORT: DFC BOARD MOUNTING	1
37	5710-227	PANEL: CONTROL MODESTY	1
38	5710-277	PILOT SHIELD	1
39	5710-279	HANDLE: SPRING HOOK	2
40	5710-290	PLATE: RESTRICTOR	1
41	7000-393	REMOTE CONTROL: PROFLAME GT,BLK	1
42	7000-394	RECEIVER: PROFLAME, TIMER	1
43	7200-241	ORIFICE: BURNER HOOD,#41 (NG)	1
44	7210-008	FITTING 90 DEG 3/8" NPT X 3/8"COMP.	1
45	7211-018	TUBE: FLEX 12"	1
46	7211-020	FITTING 90 DEG 3/8-27 X3/8" COMP.	1
47	7211-101	DFC PROFLAME CONTROL BOARD	1

48	7211-102	WIRE HARNESS: DFC	1
49	7211-103	WIRE HARNESS: REMOTE CONTROL GTMS	1
50	7211-105	FAN CONTROL MODULE	1
51	7211-110	VALVE: STEP. NG, SIT	1
52	7211-220	SHUTTER: AIR CONTROL,PRIMARY	1
53	7211-395	PILOT: NG ASS'Y, IPI	1
54	7211-588	BURNER: EMBER	1
55	93-57220	BLOWER ASSEMBLY KIT	1
56	97-59010	FRONT GLASS SCREEN	1
	97-56110	GLASS ASSEMBLY KIT	
57	3030-060	GLASS:12.75"x15.23"x5mm	1
58	3160-081	GASKET: TAPE,3/4"x1/8",AD	5.6
59	4400-0200	RIVIT: 1/8" X 1/8" SS	4
60	5322-230	FRAME: GLASS	1
61	5870-095	CLIP: GLASS	2
	97-67000	LOG SET KIT	
62	7211-590	LOG: REAR	1
63	7211-591	LOG: CENTER BASE	1
64	7211-592	LOG: RIGHT, LOWER	1
65	7211-593	LOG: RIGHT, TOP	1
66	7211-594	LOG: LEFT, TOP	1
	97-56104	SOLD SEPERATELY LP CONVERSION KIT	
67	7200-253	ORIFICE: BURNER HOOD,#53 (LP)	1
68	7211-136	LP PILOT ORIFICE: .35MM (LP)	1
69	7211-344	LP REGULATOR	1