

Overview

The SIT Proflame 2 remote may be programmed to disable the thermostat or any of the modes (flame height, blower, light, comfort control, Standing Pilot *, or auxiliary power input). This allows you to tailor the remote to the appliance.

* We do not recommend disabling the standing pilot option for our gas appliances. This feature may be recommended for cold regions or installations with sub-optimal venting.

Compatibility

- Proflame 2 Appliances (1-Piece IFC controller with battery box)
- Proflame 1 Appliances (FCM Module and Receiver)NOTE: The accent light is controlled via the AUX mode (works as on/off only).

How to Turn the Thermostat Feature On and Off

NOTE: The remote is shipped from the factory with the thermostat enabled.

1 Remove one battery from the remote.

2 Press down on the thermostat button while replacing the battery. This will toggle the thermostat function. Repeat this process to toggle the thermostat function to the desired setting.

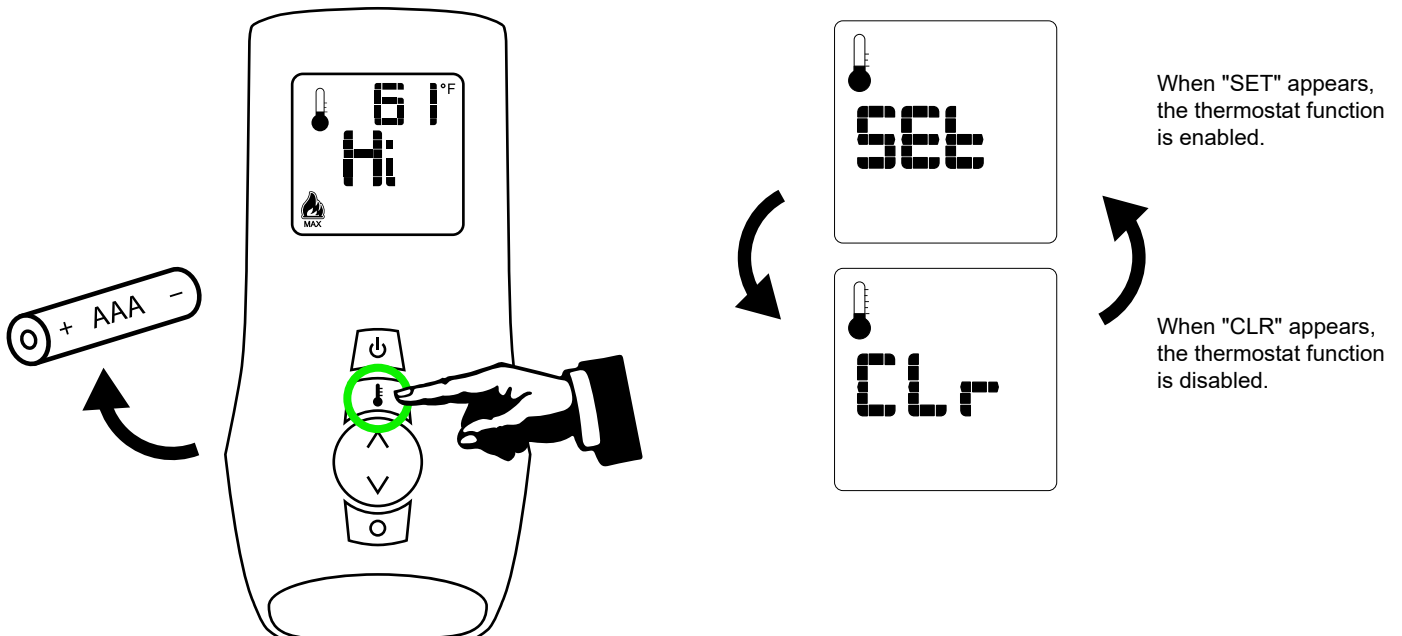

Disabling Modes From the Remote

NOTE: The remote is shipped from the factory with all modes enabled except the auxiliary (AUX) function.

- 1 Remove one battery from the remote.
- 2 Press down on the on/off button and mode button while replacing the battery. Make sure to keep the on/off button depressed during the following steps.

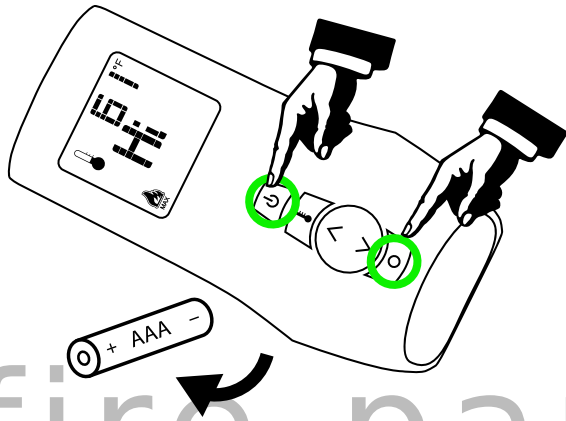

HINT:
The easiest way to do this step is to place the top battery in the holder, slightly ajar. Then hold the the buttons down as you press the battery into place.

- 3 While keeping the on/off button depressed, press and release the mode button until the mode that needs to be changed is illuminated.

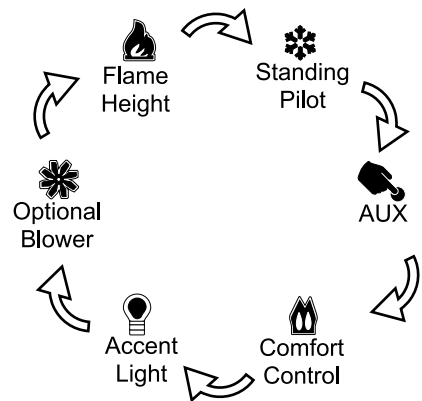
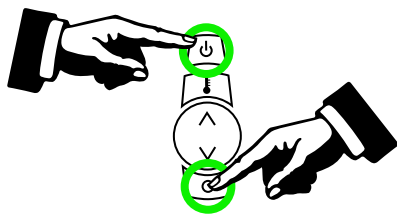
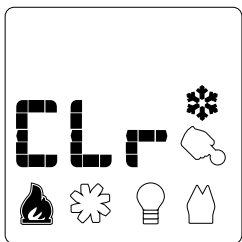

- 4 With the desired mode illuminated (the illustration below shows the AUX mode illuminated), press the "up" or "down" button to activate or clear the mode being addressed. Make sure to keep the on/off button depressed during this process.

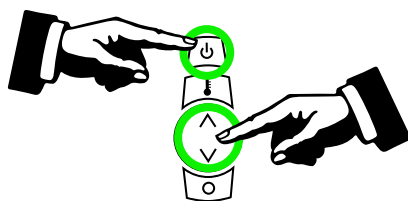
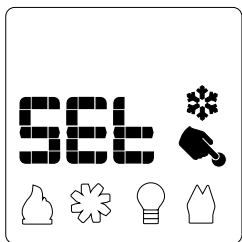

^ SET

Press the "up" button to activate ("SET") the mode selected.

v CLR

Press the "down" button to clear ("CLR") the mode selected.

- 5 Release the on/off button to complete programming.